

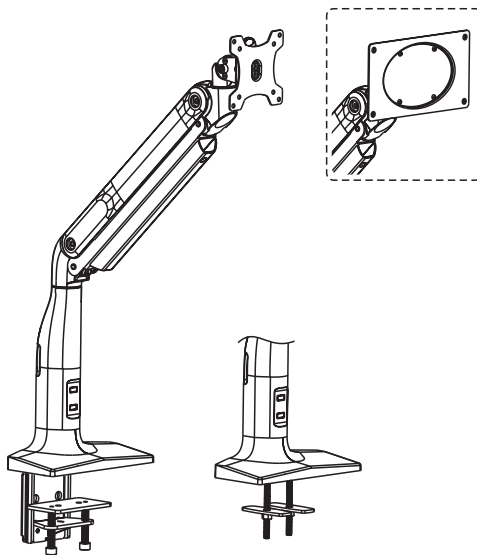

Pneumatic Arm Single Ultra Wide Monitor Desk Mount

Instruction Manual



SKU: STAND-V100H



Scan the QR code with your mobile device or follow the link for helpful videos and specifications related to this product.

<https://vivo-us.com/products/stand-v100h>

GET IN TOUCH | Monday-Friday from 7:00am-7:00pm CST



help@vivo-us.com



www.vivo-us.com
Chat live with an agent!



309-278-5303



WARNING!

If you do not understand these directions, or if you have any doubts about the safety of the installation, please call a qualified technician. Check carefully to make sure there are no missing or defective parts. Improper installation may cause damage or serious injury. Do not use this product for any purpose that is not explicitly specified in this manual. Do not exceed weight capacity. We cannot be liable for damage or injury caused by improper mounting, incorrect assembly or inappropriate use.



TIPOVER WARNING

SERIOUS OR FATAL CRUSHING INJURIES CAN OCCUR FROM TIPOVER. TO HELP PREVENT TIPOVER:

- NEVER ALLOW CHILDREN TO CLIMB, STAND, HANG, OR PLAY ON ANY PART OF MONITOR OR STAND.
- USE TIPOVER RESTRAINT OR ANCHOR STAND TO WALL

USE OF TIPOVER RESTRAINTS MAY ONLY REDUCE, BUT NOT ELIMINATE RISK OF TIPOVER.



WARNING: CHOKING HAZARD

SMALL PARTS - NOT FOR CHILDREN UNDER 3 YEARS. ADULT SUPERVISION IS REQUIRED.

PACKAGE CONTENTS

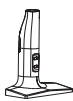

A (x1)
Base

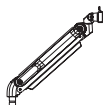

B (x1)
Arm



C (x1)
Rear Cover



D (x1)
Clamp Brace



E (x1)
Grommet
Base Plate



F (x1)
Clamp Plate



G (x1)
Clamp Bracket



H (x2)
Clamp Bolt



I (x1)
VESA 200x100
Plate



J (x1)
VESA Plate



K (x2)
Carriage Bolt



L (x2)
Support Plate



M (x2)
D8 Washer



N (x2)
M8 Nut



O (x4)
M4x12



P (x4)
M6x12



Q (x4)
D5 Washer



R (x4)
M4 Nut



S (x1)
Wrench



T (x1)
4mm Allen
Wrench



U (x1)
6mm Allen
Wrench



M-A (x4)
M4x12



M-B (x4)
M5x12



M-C (x4)
D5 Washer

TOOLS NEEDED



NOTE: SOME HARDWARE INCLUDED MAY NOT BE USED

DO NOT EXCEED WEIGHT CAPACITY.

Failure to do so may result in serious injury.



ASSEMBLY STEPS

STEP 1

OPTION A: Clamp Installation

Attach clamp brace (**D**) to base (**A**) using M6x12 bolts (**P**), and tighten with 4mm Allen wrench (**T**). Insert clamp bolts (**H**) into clamp bracket (**G**) as shown, then place clamp plate (**F**) on top of assembled clamp. Install clamp (**G**) to upper holes of clamp brace (**D**) for a desk thickness of 3/8" to 1-1/2" (10 - 40mm), or to lower holes for a desk thickness of 1-1/2" to 3-1/4" (40 - 84mm). Place assembled base on edge of desk and tighten clamp bolts evenly with 6mm Allen wrench (**U**).

OPTION B: Grommet Installation

Place carriage bolts (**K**) into square holes in grommet base plate (**E**). Attach grommet base plate to base (**A**) using M6x12 bolts (**P**), and tighten with 4mm Allen wrench (**T**). Place assembled base over cable grommet hole in desktop, and tighten using support plates (**L**), D8 washers (**M**) and M8 nuts (**N**), and tighten with wrench (**S**). If a grommet hole isn't present, drill two 3/8" (10mm) holes 49mm apart through the desktop.

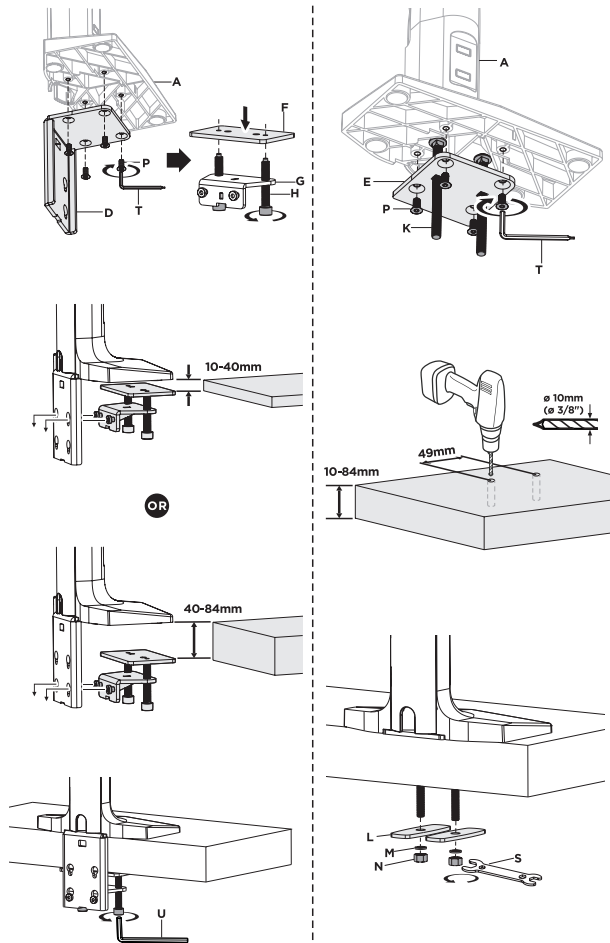

STEP 2

Insert the arm (B) into the socket of the base, then secure using the 4mm Allen wrench (T) or a flat-blade screwdriver. Install rear cover (C) to clamp brace if the clamp option was used.

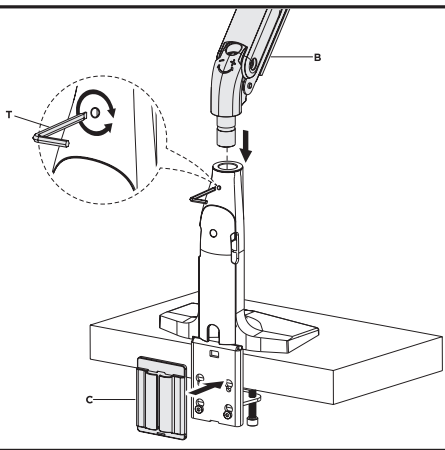

STEP 3

OPTION A: VESA 75x75, 100x100

Install the VESA plate (J) to monitor using M4x12 bolts (M-A) or M5x12 bolts (M-B) with washers (M-C), making sure the rounded edges of the rear bracket are facing up.

OPTION B: VESA 200x100

Install the VESA 200x100 plate (I) to the VESA plate (J) using the M4x12 bolts (O) with D5 washers (Q) and M4 nuts (R), tightening with the wrench (S) and a Phillips screwdriver. Mount assembled VESA plate to monitor using M4x12 bolts (M-A) or M5x12 bolts (M-B) with washers (M-C), making sure the rounded edges of the rear bracket are facing up.

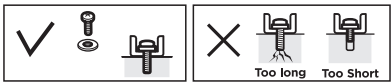

VESA:75x75 100x100

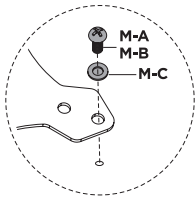
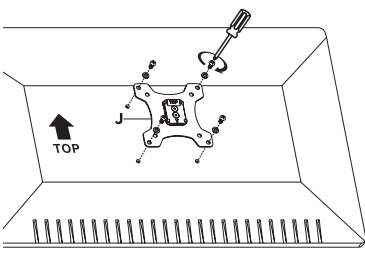

VESA:200x100

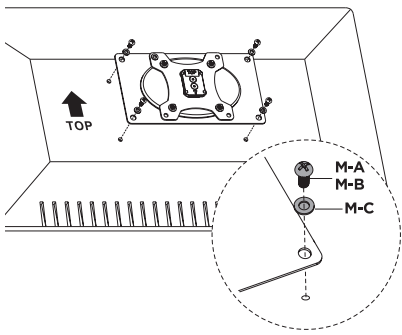
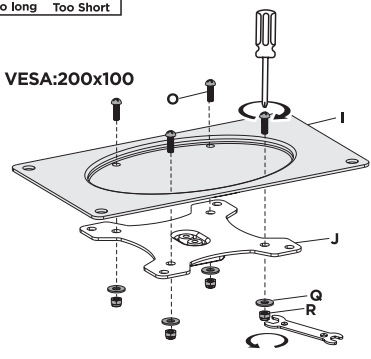

STEP 4

Pull back the latch on the support bracket at the end of the arm (**B**), then place the monitor with VESA plate onto the support bracket.

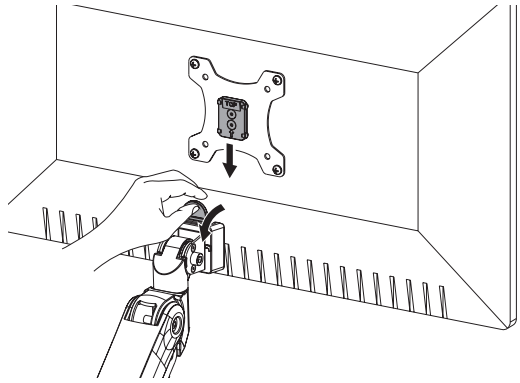

STEP 5

While holding the arm in the horizontal position, adjust the gas spring tension using the 6mm Allen wrench (**U**).

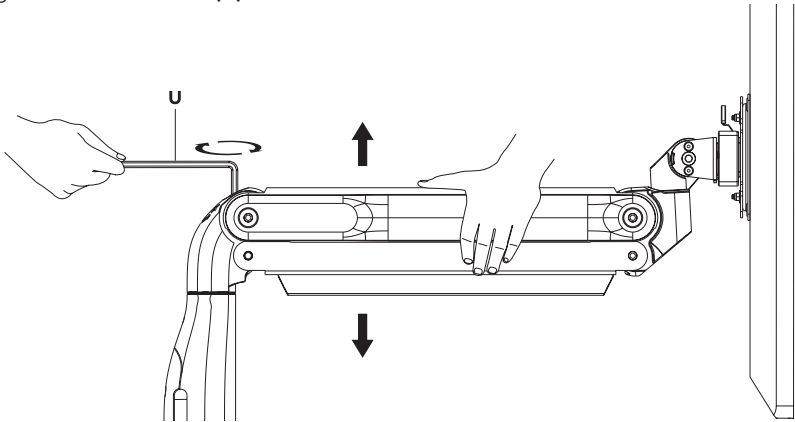

CAUTION - To avoid damage to the monitor and mount, always keep the arm in a horizontal position while making adjustments.



If the arm **drops**, turn the adjustment screw counter-clockwise until it stays in a horizontal position.

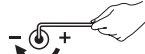

If the arm **rises**, turn the adjustment screw clockwise until it stays in a horizontal position.



DO NOT over tighten the screws.

STEP 6

Remove cable covers from base and adjustable arm. Organize cables and reinstall cable covers to base and adjustable arm.

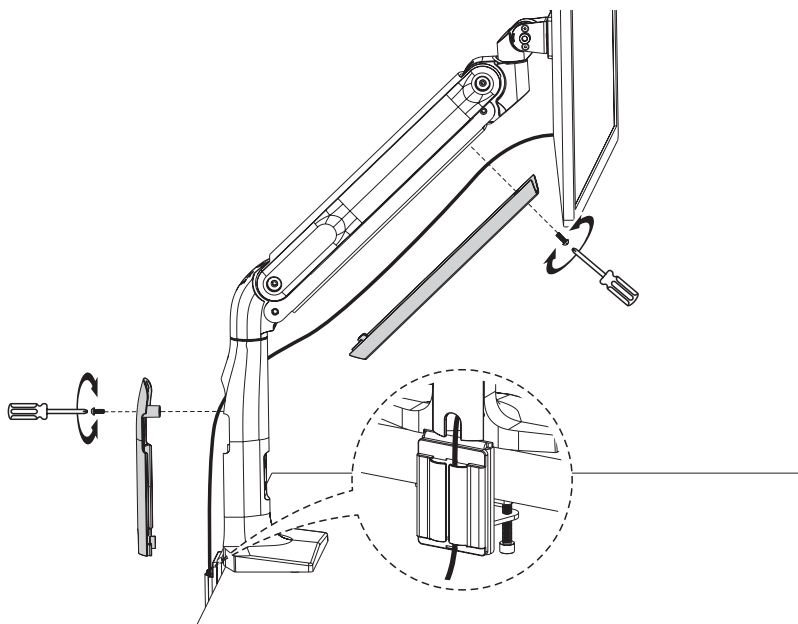

STEP 7

Tighten or loosen the tilt joint using the 6mm Allen wrench (**U**).

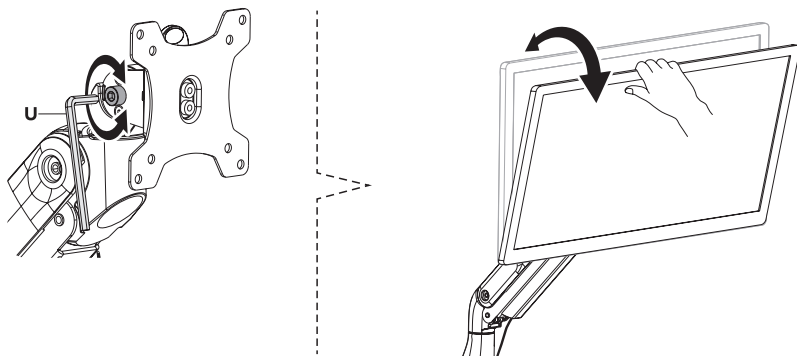

STEP 8

Adjust the monitor position as desired.

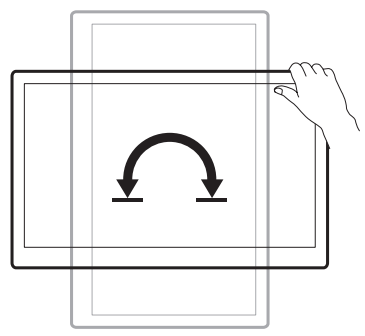
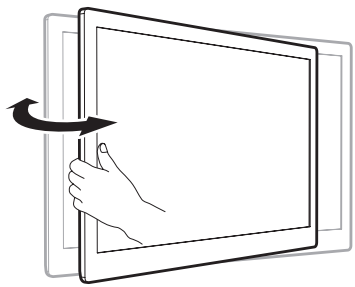





Open **Monday - Friday 7:00am - 7:00pm** CST,
our dedicated support team can offer immediate assistance with rapid response times. If any parts are received damaged or defective, please contact us. We are happy to replace parts to ensure you have a fully functioning product.

 309-278-5303

AVG. RESOLUTION TIME (*within office hrs*): **5M 4S**

 www.vivo-us.com
Chat live with an agent!

AVG. RESOLUTION TIME (*within office hrs*): **< 15 M**

 help@vivo-us.com

AVG. RESPONSE TIME (*within office hrs*): **1HR 8M**

- 23% within < 15m
- 38% within < 30m
- 61% within < 1hr
- 83% within < 2hr
- 92% within < 3hr